

WORK SAFELY

LEGEND

- Existing Trees (Symbol)
- New Trees (Symbol)
- Stormwater Main (Symbol)
- Stormwater Disposal (Symbol)
- Existing Fencing (Symbol)
- Underground Power (Symbol)
- Overhead Power (Symbol)
- 100 Dia Stormwater (Symbol)
- Trees to be removed (Symbol)
- AG Drain (Symbol)
- Sewer Pipe (Symbol)
- Fencing by Contractor (Symbol)
- Grated Drain (Symbol)

DETAILS

DATE: RL 38.405 (LARD)

CONTOUR INTERVALS: 0.20 Metres

WATER CONNECTION: (BY THE BUILDER)
20mm line from water meter to entry point.

WASTE DISPOSAL: (BY THE BUILDER)
Connection to mains sewer in accordance with local authority requirements.

ROOFWATER DISPOSAL: (BY THE BUILDER)
Connection of all downpipes to underground drain. Position of roofwater lines are indicative only and may vary depending on site.

POWER CONNECTION:
Installation of underground line by the builder. Connection of power to main line by Electricity Authority.

EARTHWORKS: (BY THE BUILDER) **AG Drains: 0 Metres**
Cut and fill to create level building platform. Remove spoil from site. Earthworks indicated on the plan are for construction purposes only.

LOCAL AUTHORITY:

TITLE PARTICULARS:

LOT: DIM PLAN:
VOL: PARISH:
FOL: COUNTY:

LOCATION: LAT: 33.92122
MAP REFERENCE: LONG: 151.05367

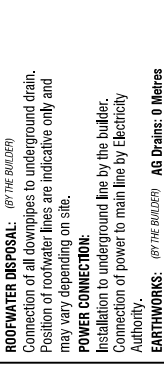

NOTE: MIN 200MM FREEBOARD
SIZE, CUT & FILL LEVELS MAY VARY DUE TO SITE CONDITIONS.

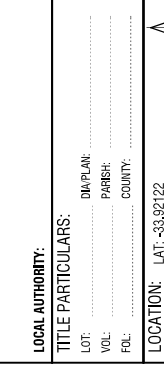

AMENDMENTS

1	DB 14.03.22	Provide N.E.C. to support 118
2	DB 17.03.22	Finalise remaining linear requirements

01-4
4 of 15

HAND: Corella

SCALE: 1:200

DESIGN ID:	198970
CONTRACT NO:	NHP
SPECIFICATION:	N.S.W.
S.I. No.:	NK 13.12.21
ISSUE:	DB 25.01.22
GEN:	DB 22.01.18
DATE:	

Shadow Diagrams

Robertson 255

RESIDENCE FOR:
Kim Sung Hee
Lot A, 33 Sharp Street,
Belmore NSW 2192

Burbank
#BurbankLocalGov
Burbank Australia (NSW) Pty Ltd. ph: (02) 9528 0335 fx: (02) 9528 0222
www.burbanklocal.gov.au
ABN: 68 610 822 770, ACR: 610 822 770, RL: 235627C

NEW HOME CONTRACT 1

LEGEND

- 9AM SHADOW (Symbol)
- 12PM SHADOW (Symbol)
- 3PM SHADOW (Symbol)

SUN ANGLES 22nd JUNE

REMAINING WALL TO REMAIN AS REQUIRED TO BE MAINTAINED AFTER SETTLEMENT